

EXECUTIVE SUITES AT RIVERCENTER

Small Suites. Big Presence.

RIVERCENTER TOWERS COVINGTON, KY



Northern Kentucky's Class A Address on the Ohio River

Located in RiverCenter Towers overlooking the Ohio River, steps from downtown Cincinnati, Executive Suites offers small suite opportunities at one of Northern Kentucky's most recognized Class A business addresses.

Discover private, move-in ready offices in Covington's Central Business District with a turnkey setup designed for productive, professional workdays. Move in and get to work. Each fully enclosed suite is lightly furnished and designed for privacy, security, and focus, ideal for confidential work and a strong client-facing presence.



PERFECT FOR:

- Startups and entrepreneurs
- Remote and hybrid professionals
- Teams expanding into Northern Kentucky
- Professionals needing a small, premium office

A professional workspace—without the overhead or long-term obligations.

TENANTS ENJOY:

- A prestigious Covington CBD address
- Access to onsite conference room and building amenities
- Walkable hotels, dining, and entertainment
- Convenient parking and on-site services
- A polished setting for client confidence

A riverfront location with visibility, convenience, and easy access to the region.

PRIVATE OFFICES BUILT FOR MODERN WORK

Skip the distractions of open coworking. These private suites ranging in size from 117 to 216 square feet support focus and discretion, ideal for legal, financial, real estate, consulting, healthcare, tech, and creative professionals. We offer a 1-year gross lease for all suites.

Features include:

- Lightly furnished, secure, enclosed office suites
- Direct access elevators with secure onsite parking garage
- Kitchenette and Free Wifi
- Shared conference rooms and amenities, including 75-seat media center
- A polished setting for meetings and daily work
- Onsite gym membership availability

A smart fit for teams that want efficiency with executive-level presence.

CONNECTED TO RIVERCENTER RETAIL & DINING

Enjoy nearby RiverCenter Retail—restaurants, cafes, and services in and around the towers—plus outdoor patio options that make the workday more convenient and enjoyable.

For professionals who value walkability and amenities, RiverCenter delivers an unmatched riverfront workplace with short-term commitments.



RIVERCENTER I EXECUTIVE SUITES 4th Floor

For Current
Availability

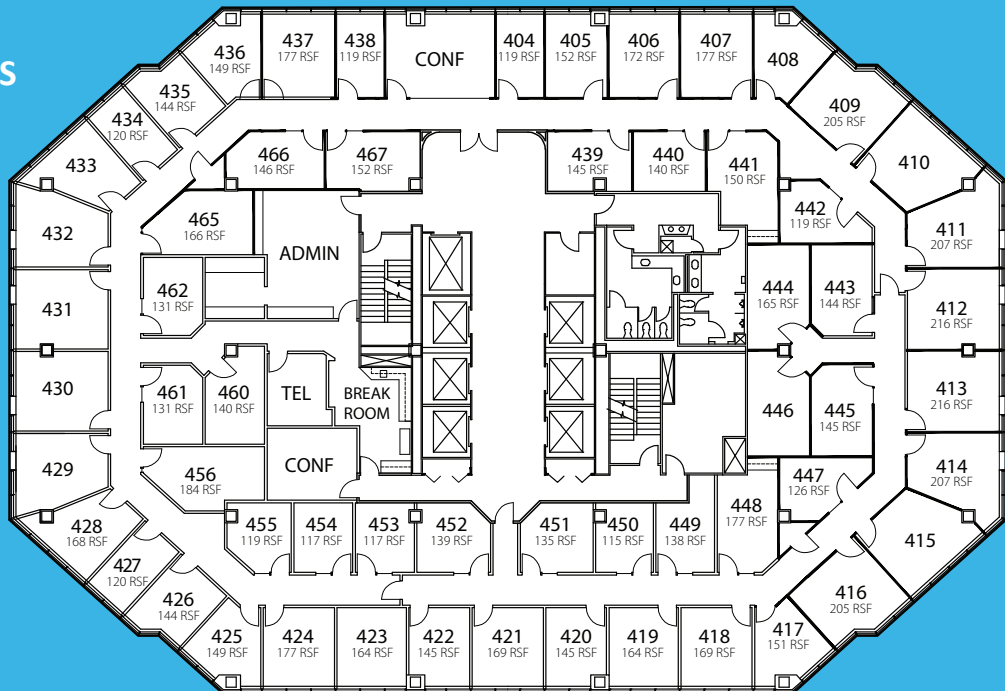

**FOR MORE INFORMATION
OR TO SCHEDULE A TOUR**



Annashea Carlisle
Leasing Specialist
acarlisle@corporex.com
513.600.5455 cell

100 E. RiverCenter Blvd.
Suite 1100
Covington, KY 41011

Corporex
corporex.com